

Bahnhofshalle.01 (station hall)

Installation : Fresnel-Spiegel + Sistar System

Project number : Musteranlage (standard exemple)

Customer :

Processed by : Siteco

Date : 01.2007

Project description:

Raumabmessung (room dimention) L/B/H: 75/35/29 m

Fresnel-Spiegel (reflector)/ 1,2 x 1,2m/ asym. 10° Neigung;
Montagehöhe (montagehight) = 28 m

Sicomcompact R2 Maxi (projector); 1x HIT 1000W;
Montagehöhe (montagehight) = 25 m

Die Ermittlung der Beleuchtungsergebnisse erfolgte verkaufsunterstützend mit größter Sorgfalt auf Basis der uns vorliegenden Unterlagen mit Hilfe von marktüblichen Berechnungsverfahren (z.B. Relux, Dialux).

Eine Garantie / Gewährleistung / Haftung für diese kostenlose Errechnung wird von SITECO nicht übernommen. Wir verweisen in diesem Zusammenhang auf die Leistungen der Lichtplanungs- u. Ingenieurbüros.

The determination of the lighting results is performed on a sales support basis, with great thoroughness, using the documents at our disposal and with the aid of calculating procedures customary in the market (e.g. Relux, Dialux).

A guarantee / warranty / liability for this free calculation is not provided by SITECO. In this respect, we refer to the services of the light planning and engineering office.

The following values are based on exact calculations on calibrated lamps, luminaires and their arrangement. In practice, gradual divergences can occur.

Guarantee claims for luminaire data are excluded.

Relux and the luminaire manufacturers accept no liability for consequential damage and damage which is occasioned to the user or to third parties.

Object : Bahnhofshalle.01 (station hall)
Installation : Fresnel-Spiegel + Sistar System
Project number : Musteranlage (standard exemple)
Date : 01.2007

Table of contents

First Page	1
Table of contents	2
1 Luminaire data	
1.1 Siteco, SiCOMPACT R2 MAXI (!5NA 726 0-1VS11C)	
1.1.1 Data sheet	3
1.2 Siteco, 5NW 140 9-1QB10st, Fre... (!5NW 140 9-1QB10st)	
1.2.1 Data sheet	4
2 Aussenanlage	
2.1 Description, Aussenanlage	
2.1.1 Floor plan	5
2.2 Summary, Aussenanlage	
2.2.1 Result overview, Measuring area (virtual) 1	6
2.2.2 Result overview, Measuring area (virtual) 2	7
2.2.3 Result overview, Measuring area (virtual) 3	8
2.3 Calculation results, Aussenanlage	
2.3.1 3D luminance, View 1	9
2.3.2 3D luminance, View from the front	10
2.3.3 3D luminance, View from the back	11

Object : Bahnhofshalle.01 (station hall)
Installation : Fresnel-Spiegel + Sistar System
Project number : Musteranlage (standard exemple)
Date : 01.2007

1 Luminaire data

1.1 Siteco, SiCOMPACT R2 MAXI (!5NA 726 0-1VS11C)

1.1.1 Data sheet

Manufacturer: Siteco

!5NA 726 0-1VS11C Rotationssymmetrischer Scheinwerfer SiCOMPACT R2 MAXI

Leuchtgehäuse aus Aluminiumdruckguss, grau lackiert (RAL 7036)
mit Zündgerät für Normalzündung, ohne Vorschaltgerät, Betrieb nur mit geeignetem Vorschaltgerät (separat zu bestellen)
chemisch gehärtetes Abdeckglas mit Schutzgitter
eng bündelnd
Schutzart:IP 65
Montageart:Flutlicht

Luminaire data

Luminaires efficiency : 86.6% (A60)
Control gear : VG
System power : 1065 W
Diameter : 491 mm
Height : 363 mm

Equipped with

Number of : 1
Designation : HIT-DE
Power : 1000 W
Colour :
Luminous flux : 0 lm

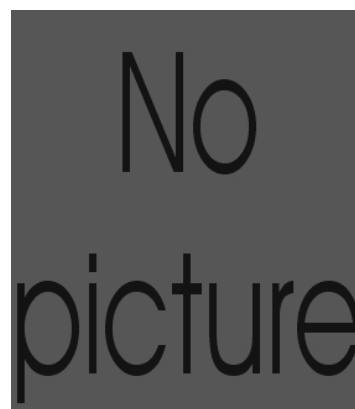
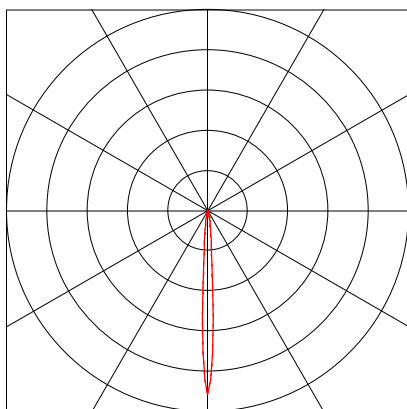

Object : Bahnhofshalle.01 (station hall)
Installation : Fresnel-Spiegel + Sistar System
Project number : Musteranlage (standard exemple)
Date : 01.2007

1 Luminaire data

1.2 Siteco, 5NW 140 9-1QB10st, Fre... (!5NW 140 9-1QB10st)

1.2.1 Data sheet

Manufacturer: Siteco

!5NW 140 9-1QB10st

5NW 140 9-1QB10st, Fresnel-Spiegeasym., Spiegelneigung 10°

Luminaire data

Luminaires efficiency : 83.5% (A20)
Control gear :
Length : 1200 mm
Width : 1200 mm
Height : 20 mm

Equipped with

Number of : 1
Designation :
Power : W
Colour :
Luminous flux : 75000 lm

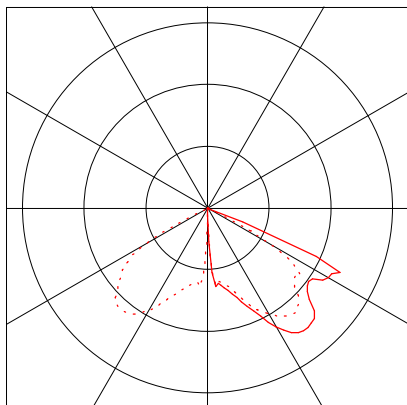

Object : Bahnhofshalle.01 (station hall)
Installation : Fresnel-Spiegel + Sistar System
Project number : Musteranlage (standard exemple)
Date : 01.2007

2 Aussenanlage

2.1 Description, Aussenanlage

2.1.1 Floor plan

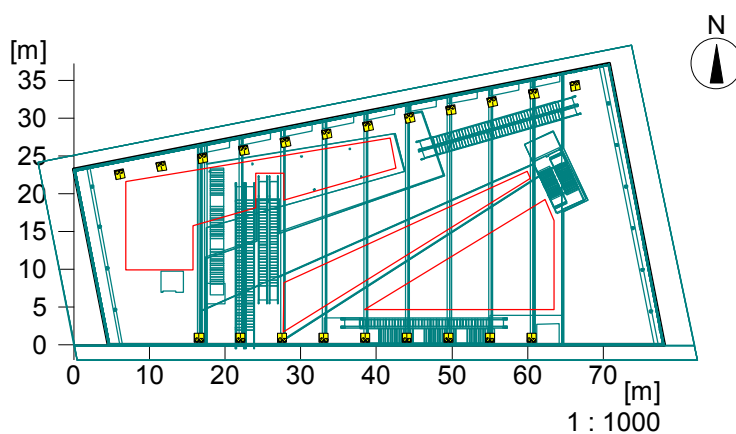

Object : Bahnhofshalle.01 (station hall)
 Installation : Fresnel-Spiegel + Sistar System
 Project number : Musteranlage (standard exemple)
 Date : 01.2007

2 Aussenanlage

2.2 Summary, Aussenanlage

2.2.1 Result overview, Measuring area (virtual) 1

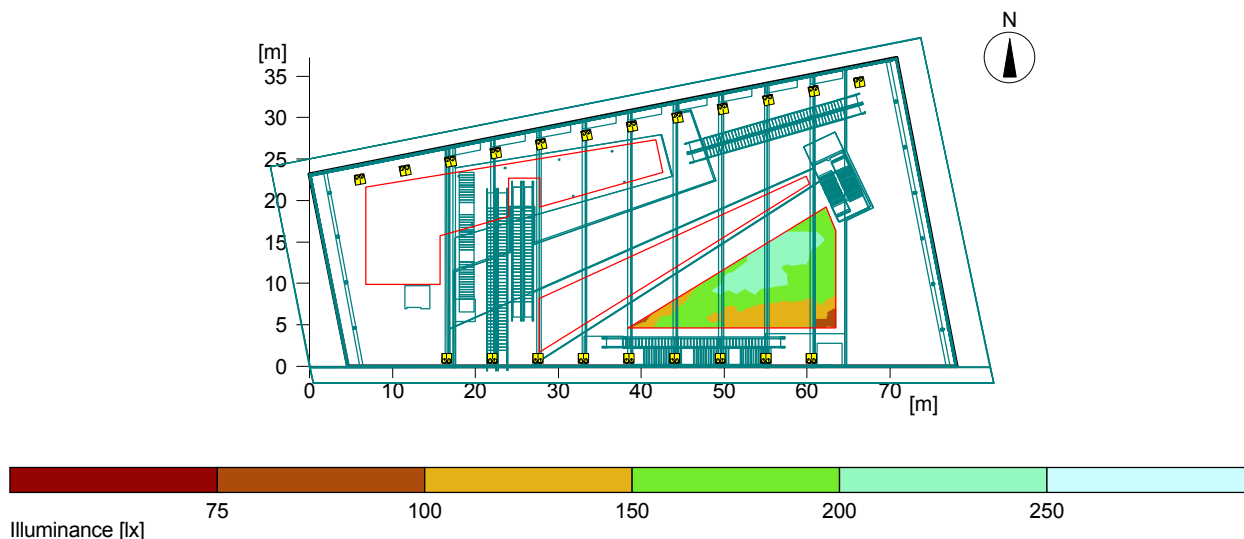

General

Calculation algorithm used	Average indirect fraction
Height of evaluation surface	0.20 m
Reduction factor	0.67

Total luminous flux of all lamps	1575000 lm
Total power	44730 W
Total power per area (2218.95 m ²)	20.16 W/m ²

Illuminance

Average illuminance	Eav	169 lx
Minimum illuminance	Emin	96 lx
Maximum illuminance	Emax	227 lx
Uniformity g1	Emin/Em	1:1.76 (0.57)
Uniformity g2	Emin/Emax	1:2.36 (0.42)

Type No.\Make

		Siteco	
1	42	Order No.	: !5NA 726 0-1VS11C
		Luminaire name	: SiCOMPACT R2 MAXI
		Equipment	: 1 x HIT-DE 1000 W / 0 lm
2	21	Order No.	: !5NW 140 9-1QB10st
		Luminaire name	: 5NW 140 9-1QB10st, Fresnel-Spiegeasym., Spiegelneigung 10°
		Equipment	: 1 x W / 75000 lm

Object : Bahnhofshalle.01 (station hall)
 Installation : Fresnel-Spiegel + Sistar System
 Project number : Musteranlage (standard exemple)
 Date : 01.2007

2.2 Summary, Aussenanlage

2.2.2 Result overview, Measuring area (virtual) 2

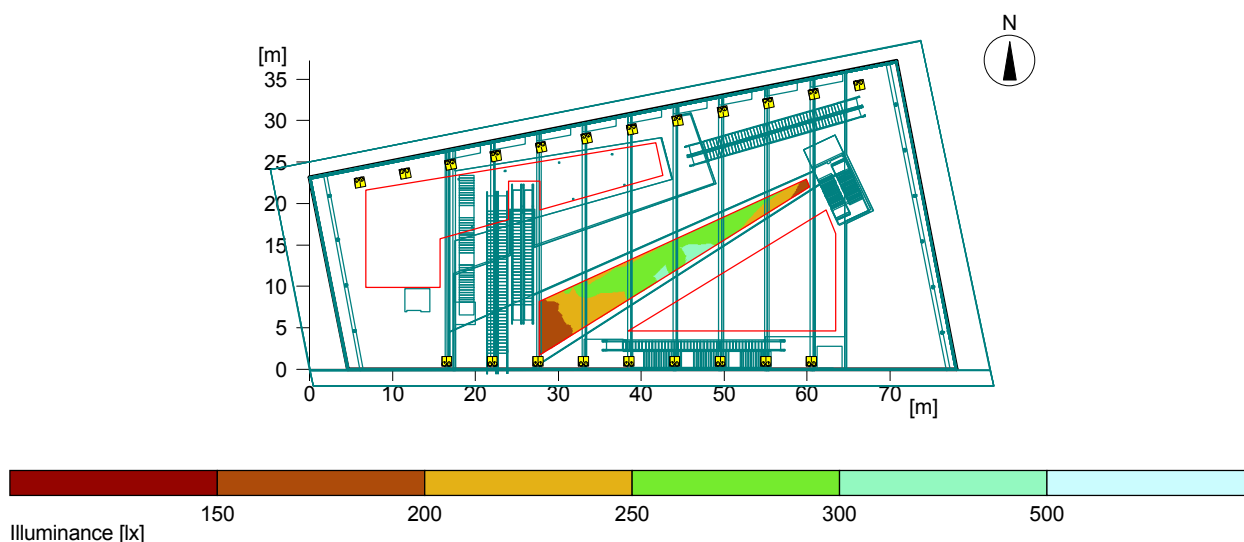

General

Calculation algorithm used	Average indirect fraction
Height of evaluation surface	2.90 m
Reduction factor	0.67

Total luminous flux of all lamps	1575000 lm
Total power	44730 W
Total power per area (2218.95 m ²)	20.16 W/m ²

Illuminance

Average illuminance	Eav	249 lx
Minimum illuminance	Emin	146 lx
Maximum illuminance	Emax	315 lx
Uniformity g1	Emin/Em	1:1.71 (0.59)
Uniformity g2	Emin/Emax	1:2.16 (0.46)

Type No.\Make

		Siteco	
1	42	Order No.	: !5NA 726 0-1VS11C
		Luminaire name	: SiCOMPACT R2 MAXI
		Equipment	: 1 x HIT-DE 1000 W / 0 lm
2	21	Order No.	: !5NW 140 9-1QB10st
		Luminaire name	: 5NW 140 9-1QB10st, Fresnel-Spiegeasym., Spiegelneigung 10°
		Equipment	: 1 x W / 75000 lm

Object : Bahnhofshalle.01 (station hall)
 Installation : Fresnel-Spiegel + Sistar System
 Project number : Musteranlage (standard exemple)
 Date : 01.2007

2.2 Summary, Aussenanlage

2.2.3 Result overview, Measuring area (virtual) 3

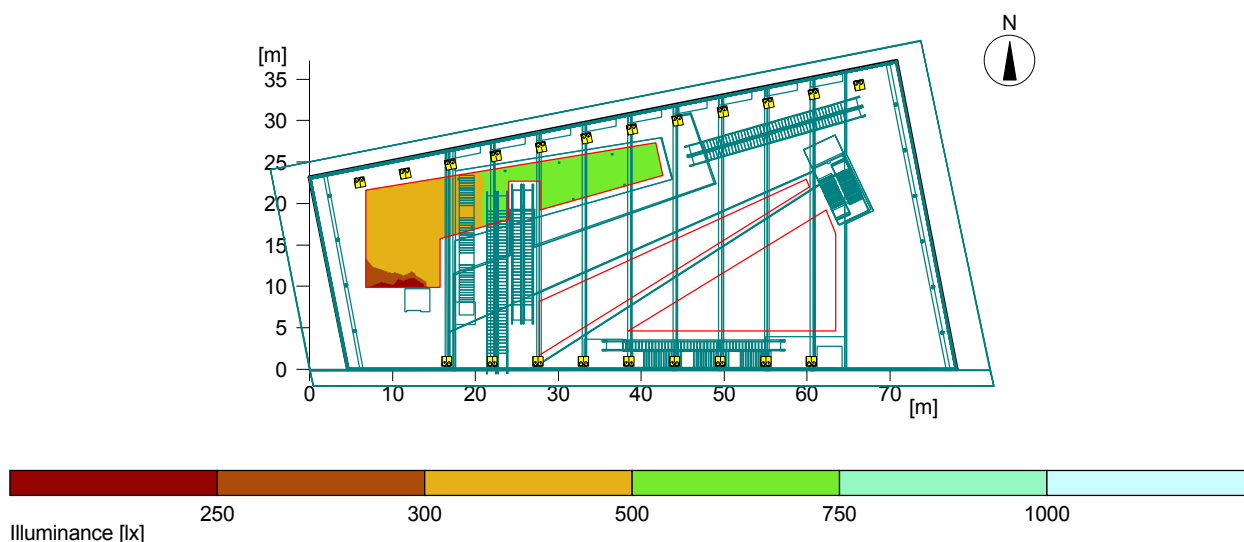

General

Calculation algorithm used	Average indirect fraction
Height of evaluation surface	15.40 m
Reduction factor	0.67

Total luminous flux of all lamps	1575000 lm
Total power	44730 W
Total power per area (2218.95 m ²)	20.16 W/m ²

Illuminance

Average illuminance	Eav	463 lx
Minimum illuminance	Emin	293 lx
Maximum illuminance	Emax	543 lx
Uniformity g1	Emin/Em	1:1.58 (0.63)
Uniformity g2	Emin/Emax	1:1.85 (0.54)

Type No.\Make

		Siteco	
1	42	Order No.	: !5NA 726 0-1VS11C
		Luminaire name	: SiCOMPACT R2 MAXI
		Equipment	: 1 x HIT-DE 1000 W / 0 lm
2	21	Order No.	: !5NW 140 9-1QB10st
		Luminaire name	: 5NW 140 9-1QB10st, Fresnel-Spiegeasym., Spiegelneigung 10°
		Equipment	: 1 x W / 75000 lm

Object : Bahnhofshalle.01 (station hall)
Installation : Fresnel-Spiegel + Sistar System
Project number : Musteranlage (standard exemple)
Date : 01.2007

2 Aussenanlage

2.3 Calculation results, Aussenanlage

2.3.1 3D luminance, View 1

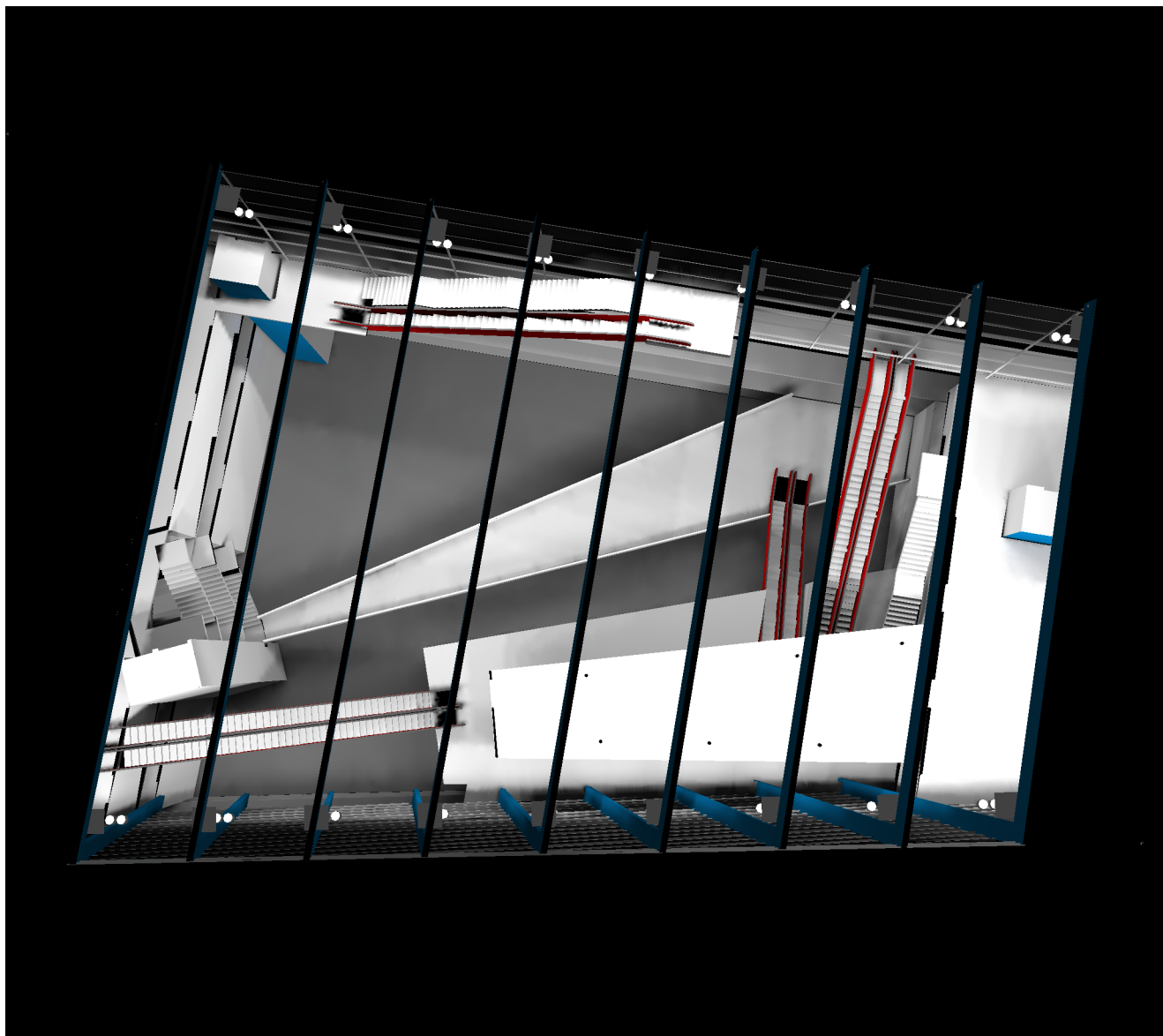

Luminance in the scene

Minimum: : 0 cd/m²
Maximum: : 247 cd/m²

Object : Bahnhofshalle.01 (station hall)
Installation : Fresnel-Spiegel + Sistar System
Project number : Musteranlage (standard exemple)
Date : 01.2007

2.3 Calculation results, Aussenanlage

2.3.2 3D luminance, View from the front

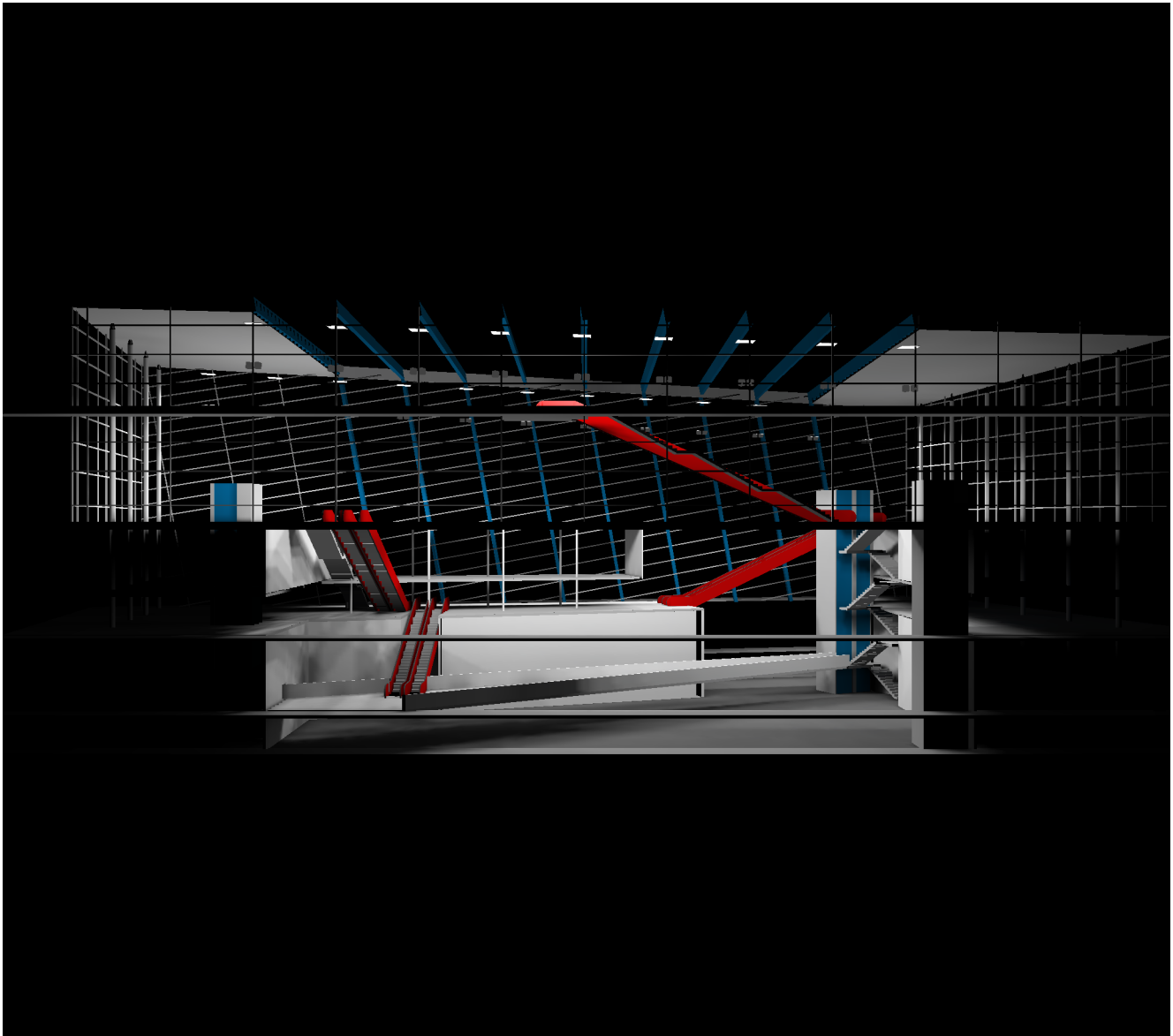

Luminance in the scene

Minimum: : 0 cd/m²

Maximum: : 247 cd/m²

Object : Bahnhofshalle.01 (station hall)
Installation : Fresnel-Spiegel + Sistar System
Project number : Musteranlage (standard exemple)
Date : 01.2007

2.3 Calculation results, Aussenanlage

2.3.3 3D luminance, View from the back

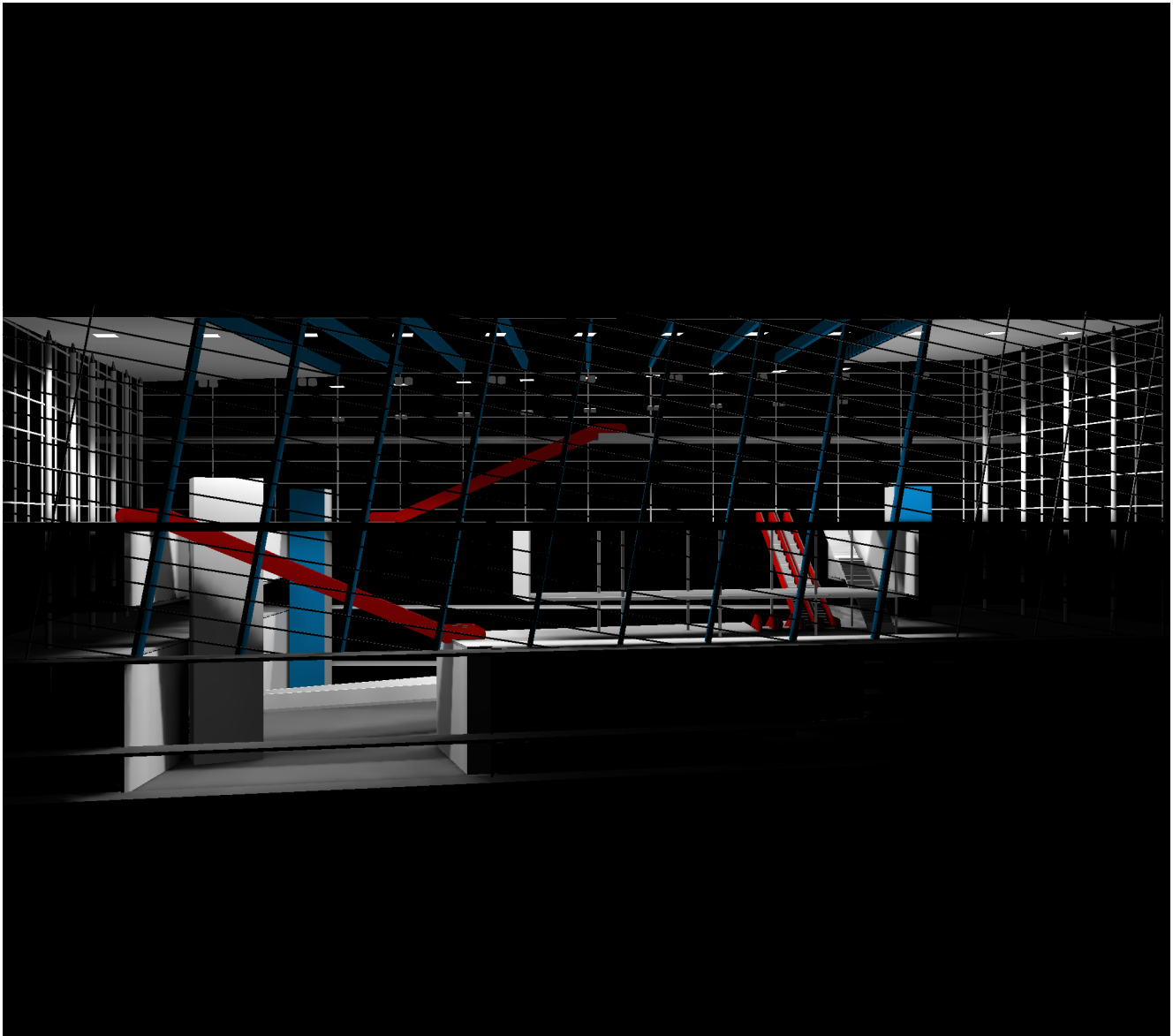

Luminance in the scene

Minimum: : 0 cd/m²

Maximum: : 247 cd/m²