

**Order No.:** 59MX1CW000WA | **GTIN (EAN):** 4058352608791

**Product description:** Sil21,SensMoPC3S,lokCtrl,PIR-sens



Silica® 21sensor module PC3-S, slave, local control, dimmable, installation arrangement: single/continuous arrangement, installation type: slip-in mounting, installation location: to the luminaire, of extruded aluminium section, protection rating (complete): IP20, insulation class (complete): insulation class I (protective earthing), certification: CE, 1 x PIR movement sensor, 1 x light sensor, packaging unit: 1 piece

IP 20  

Wt. (kg): 0.5  
GTIN (EAN): 4058352608791

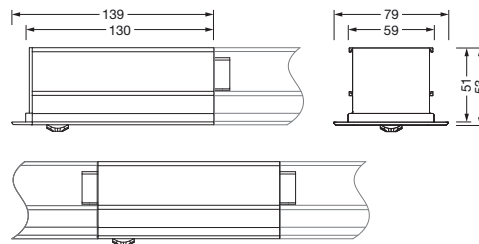

It is mandatory that the assembly instructions must be observed when planning and installing the electrical installation (to be found at [www.siteco.de](http://www.siteco.de))

Tolerances related to thermal, electrical and photometric data according to IEC 62722

Issued 17.11.2023 - Modifications and errors subject to change - Ensure that you always use the latest version -

**Order No.:** 59MX1CW000WA | **GTIN (EAN):** 4058352608791

**Detailed technical description:** Sil21,SensMoPC3S,IokCtrl,PIR-sens

#### Key data

- System family: SITECO Connect 31 Wireless
- Product type: lighting management components
- Product name: Silica® 21
- Order No.: 59MX1CW000WA

#### Lighting technology | Lamps | Control gear

##### Component 1

#### Operating device:

- Control: Bluetooth® mesh 4.2, dimmable

#### Certificates, Standards

- Protection rating: IP20
- Insulation class: insulation class I (protective earthing)
- Temperature range (operation): 0...+40°C
- Certification, designation: CE

#### Material, Colour

- housing: extruded aluminium section, anodised, traffic white (RAL 9016), for luminaires with darklight reflector
- Colour specification: traffic white (RAL 9016)

#### Mounting

- Mounting method, mounting location: slip-in mounting, to the luminaire
- Mounting height: 2.5...5m
- Arrangement: single/continuous arrangement
- Supplement: for recessed luminaires

#### Dimensions, Weight

- Length: 139mm
- Width: 53mm
- Height: 54mm
- Weight: 0.5kg

#### Inputs

##### 1x PIR movement sensor

- Connection: PIR sensor (passive-infrared)

Order No.: 59MX1CW000WA | GTIN (EAN): 4058352608791

Dimensions: Sil21,SensMoPC3S,IokCtrl,PIR-sens

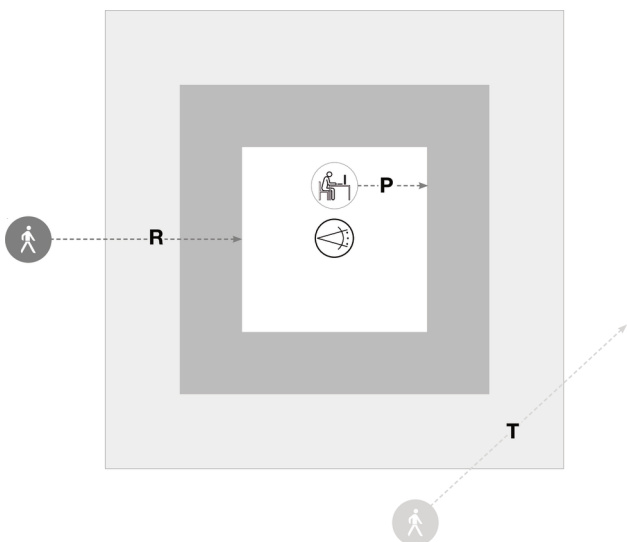
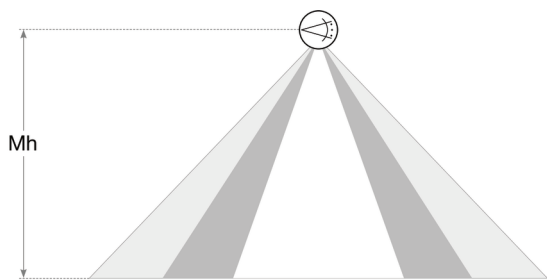
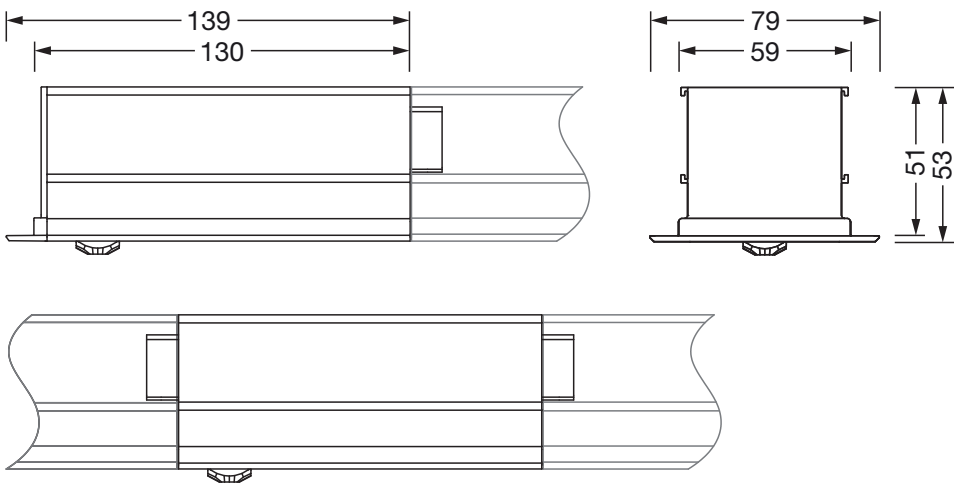

Sensor PS3

Mh	R	T	P
2,8m	4x4m	ca. 4x5m	ca. 2x2m

It is mandatory that the assembly instructions must be observed when planning and installing the electrical installation (to be found at [www.siteco.de](http://www.siteco.de))

Tolerances related to thermal, electrical and photometric data according to IEC 62722

Issued 17.11.2023 - Modifications and errors subject to change - Ensure that you always use the latest version -