

Order No.: 5LZ930200 | **GTIN (EAN):** 4058352385944

Product description: SCon11,DALI2term

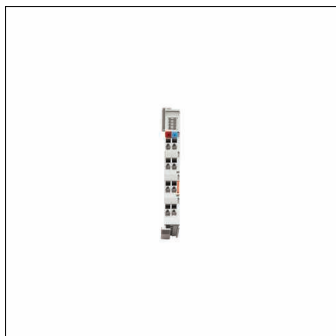

SITECO Connect 11DALI-2 terminal, central control - connection to lighting or building management, installation type: recessed, installation location: in an electrical distributor, protection rating (complete): IP20, certification: CE, voltage: 24V, voltage type: DC, 1 x K-Bus, 2 x digital switching contact, 1 x DALI-2, packaging unit: 1 piece

IP 20 

Wt. (kg): 0.1
GTIN (EAN): 4058352385944

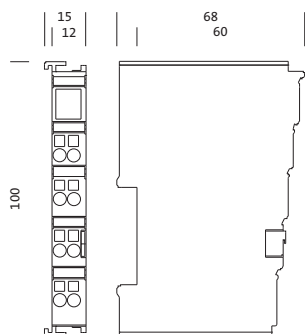

It is mandatory that the assembly instructions must be observed when planning and installing the electrical installation (to be found at www.siteco.de)

Tolerances related to thermal, electrical and photometric data according to IEC 62722

Issued 09.04.2025 - Modifications and errors subject to change - Ensure that you always use the latest version -

Order No.: 5LZ930200 | **GTIN (EAN):** 4058352385944

Detailed technical description: SCon11,DALI2term

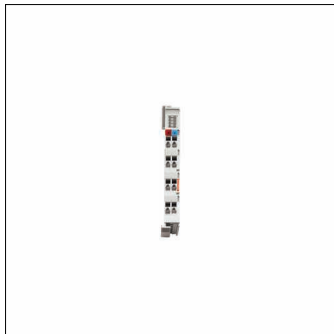

Key data

- System family: Siteco Connect 11
- Product type: control unit
- Product name: SITECO Connect 11
- Order No.: 5LZ930200

Lighting technology | Lamps | Control gear

Component 1

Operating device:

- Control: DALI 2

Certificates, Standards

- Protection rating: IP20
- Temperature range (operation):
0..+55°C
- Certification, designation: CE

Material, Colour

- Colour specification: grey

Mounting

- Mounting method, mounting location:
recessed, in an electrical distributor

Electrical connection

- Nominal voltage: 24V, DC

Dimensions, Weight

- Length: 100mm
- Width: 12mm
- Height: 68mm
- Weight: 0.1kg

Inputs

1x K-Bus

- Option: system current 55mA

2x digital switching contact

- Option: for easy commissioning

Outputs

1x DALI-2

- Connection: plug-in terminal, 2x 2-pole,
max. 2.5mm²
- Protocol: according to current DALI-2
standard
- Feature: integrated power supply
(250mA per DALI line)

It is mandatory that the assembly instructions must be observed when planning and installing the electrical installation (to be found at www.siteco.de)

Tolerances related to thermal, electrical and photometric data according to IEC 62722

Issued 09.04.2025 - Modifications and errors subject to change - Ensure that you always use the latest version -

Order No.: 5LZ930200 | **GTIN (EAN):** 4058352385944

Dimensions: SCon11,DALI2term

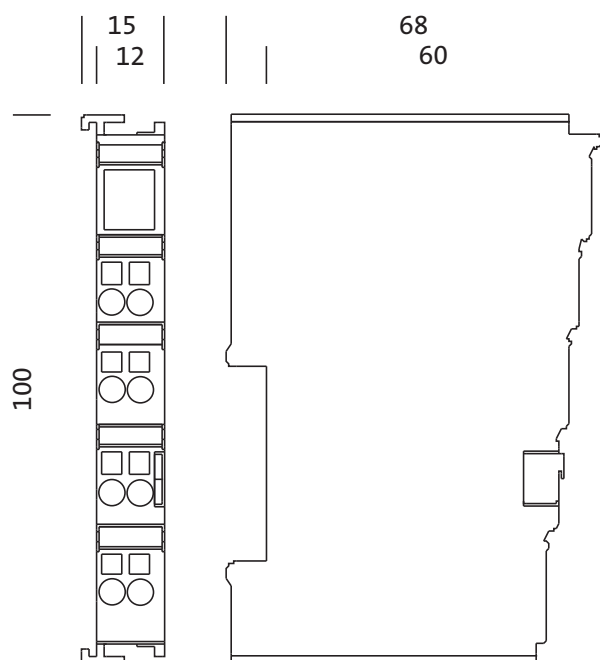

It is mandatory that the assembly instructions must be observed when planning and installing the electrical installation (to be found at www.siteco.de)

Tolerances related to thermal, electrical and photometric data according to IEC 62722

Issued 09.04.2025 - Modifications and errors subject to change - Ensure that you always use the latest version -