

Order No.: 5LZ930102 | **GTIN (EAN):** 4058352385920

Product description: SCon11,basepackM/D,swpreinstTC3



SITECO Connect 11base package M/D, DIN rail PC, 1..40 DALI lines, central control - connection to lighting or building management, installation type: recessed, installation location: in an electrical distributor, protection rating (complete): IP20, insulation class (complete): insulation class I (protective earthing), certification: CE, voltage: 230V, voltage type: AC, 1 x DALI-2, software: Lighting Solution, packaging unit: 1 piece

IP 20  

Wt. (kg): 0.6
GTIN (EAN): 4058352385920

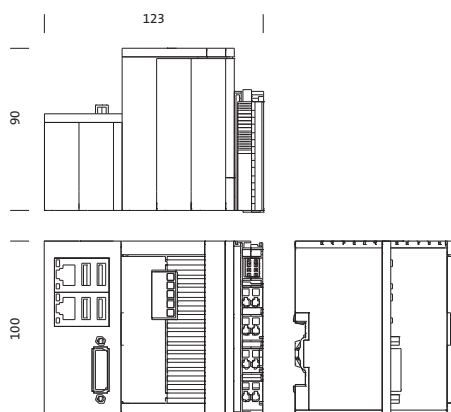

It is mandatory that the assembly instructions must be observed when planning and installing the electrical installation (to be found at www.siteco.com)

Tolerances related to thermal, electrical and photometric data according to IEC 62722

Issued 09.04.2025 - Modifications and errors subject to change - Ensure that you always use the latest version -

Order No.: 5LZ930102 | **GTIN (EAN):** 4058352385920

Detailed technical description: SCon11,basepackM/D,swpreinstTC3



Key data

- System family: Siteco Connect 11
- Product type: control unit
- Product name: SITECO Connect 11
- Order No.: 5LZ930102

Lighting technology | Lamps | Control gear

Component 1

Operating device:

- Control: DALI 2

Certificates, Standards

- Protection rating: IP20
- Insulation class: insulation class I (protective earthing)
- Certification, designation: CE

Material, Colour

- housing: plastic, grey
- Colour specification: grey

Mounting

- Mounting method, mounting location: recessed, in an electrical distributor

Electrical connection

- Nominal voltage: 230V, AC

Dimensions, Weight

- Weight: 0.6kg

Outputs

1x DALI-2

- Protocol: according to current DALI-2 standard
- Feature: integrated power supply (250mA per DALI line)

Software

- Software: Lighting Solution
- Supplement: software pre-installed, TC3 licences (platform 30) TC3 PLC, TC3 PLC HMI, TC3 PLC HMI Web, TC3 XLS

Order No.: 5LZ930102 | GTIN (EAN): 4058352385920

Dimensions: SCon11,basepackM/D,swpreinstTC3

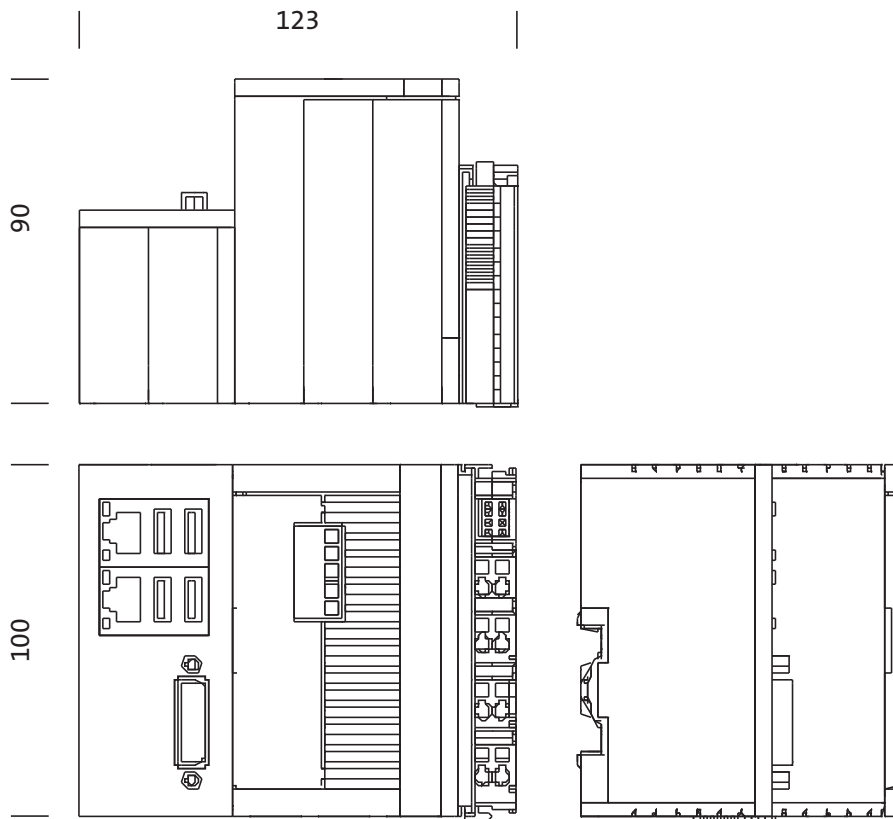

It is mandatory that the assembly instructions must be observed when planning and installing the electrical installation (to be found at www.siteco.com)

Tolerances related to thermal, electrical and photometric data according to IEC 62722

Issued 09.04.2025 - Modifications and errors subject to change - Ensure that you always use the latest version -