

Order No.: 51MR34FD0421B | **GTIN (EAN):** 4058352829776

Product description: Round21S,opal,dir,3900lm840,DA2,bk



Round 21 S, wall and ceiling luminaire, primary optical cover: cover, of PMMA, opal, light emission: direct distribution, primary light characteristic: symmetric, installation type: suspended mounting, surface-mounted, LED, rated luminous flux: 3.900lm, luminous efficacy: 129lm/W, light colour: 840, colour temperature: 4000K, control gear: DALI 2, with terminal, 5-pole, mains connection: 230V, AC, 50/60Hz, rated input power: 30.3W, housing, of aluminium, coated, black, diameter: 400mm, height: 62mm, protection rating (complete): IP40, insulation class (complete): insulation class I (protective earthing), certification: CE, impact resistance: IK04, permissible operating ambient temperature: -10...+35°C, packaging unit: 1 piece

IP 40  

| | |
|-------------|---------------|
| Lamps: | LED |
| Wt. (kg): | 3.1 |
| GTIN (EAN): | 4058352829776 |

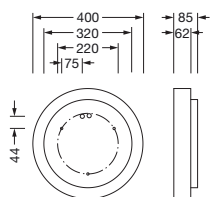

It is mandatory that the assembly instructions must be observed when planning and installing the electrical installation (to be found at www.siteco.com)

Tolerances related to thermal, electrical and photometric data according to IEC 62722

Issued 09.04.2025 - Modifications and errors subject to change - Ensure that you always use the latest version -

Order No.: 51MR34FD0421B | **GTIN (EAN):** 4058352829776

Detailed technical description: Round21S,opal,dir,3900lm840,DA2,bk



Key data

- Product type: wall and ceiling luminaire
- Product name: Round 21 S
- Order No.: 51MR34FD0421B

Lighting technology | Lamps | Control gear

Component 1

Lighting technology:

- Cover: cover, opal
- Beam angle: 105°
- Symmetry: symmetric
- Light emission: direct distribution
- UGR viewing direction along longitudinal luminaire axis: ≤ 25
- UGR viewing direction along lateral luminaire axis: ≤ 25

Lamps:

- Lamps: with LED
- Rated luminous flux: 3900lm
- Luminous efficacy: 129lm/W
- Colour temperature: 4000K
- Colour rendering index: CRI > 80
- Light colour: 840
- SDCM (Standard Deviation of Colour Matching): MacAdam ≤ 3 SDCM (initial)
- Rated input power: 30.3W

Operating device:

- Control: DALI 2

Certificates, Standards

- Protection rating: IP40
- Insulation class: insulation class I (protective earthing)
- Impact resistance: IK04
- Temperature range (operation): -10..+35°C
- Certification, designation: CE

Material, Colour

- housing: aluminium, coated, black
- Colour specification: black
- Cover: cover of PMMA

Mounting

- Mounting method, mounting location: suspended mounting, surface-mounted, to the ceiling, to the wall
- Arrangement: single arrangement

Electrical connection

- Connection: terminal, 5-pole
- Nominal voltage: 230V, 50/60Hz, AC

Dimensions, Weight

- Diameter: 400mm
- Height: 62mm
- Weight: 3.1kg

Service life

- Rated service life: 50000h (L80/B20) at AT = 25°C

Order No.: 51MR34FD0421B | **GTIN (EAN):** 4058352829776

Dimensions: Round21S,opal,dir,3900lm840,DA2,bk

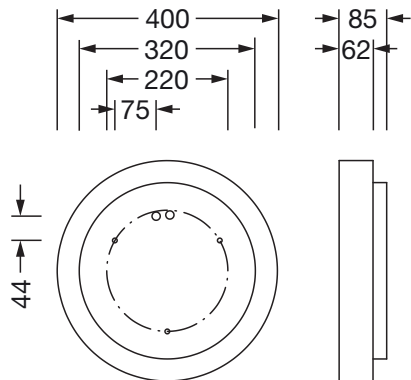

It is mandatory that the assembly instructions must be observed when planning and installing the electrical installation (to be found at www.siteco.com)

Tolerances related to thermal, electrical and photometric data according to IEC 62722

Issued 09.04.2025 - Modifications and errors subject to change - Ensure that you always use the latest version -