

Order No.: 51MP25WD2441EA | **GTIN (EAN):** 4069025077882

Product description: Apol31Sf,1245x200,3800lm840,DA2



Apollon® 31 Surface, office luminaire, primary optical cover: micro prismatic cover, of PMMA, light emission: direct distribution, primary light characteristic: symmetric, installation type: surface-mounted, LED, rated luminous flux: 3.800lm, luminous efficacy: 134lm/W, light colour: 840, colour temperature: 4000K, control gear: DALI 2, with terminal, 5-pole, mains connection: 220..240V, AC, 50/60Hz, rated input power: 28W, housing, of sheet steel, coil coated, metallic grey (RAL 9006), length: 1.245mm, width: 200mm, height: 44mm, protection rating (complete): IP20, insulation class (complete): insulation class II (safety insulation), certification: CE, impact resistance: IK02, permissible operating ambient temperature: -20..+40°C, standard: EN 60598-2-22, packaging unit: 1 piece

IP 20  

Lamps:	LED
Wt. (kg):	3.4
GTIN (EAN):	4069025077882

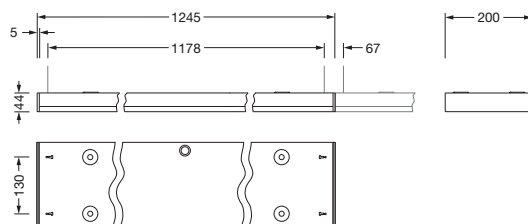

It is mandatory that the assembly instructions must be observed when planning and installing the electrical installation (to be found at www.siteco.com)

Tolerances related to thermal, electrical and photometric data according to IEC 62722

Issued 09.04.2025 - Modifications and errors subject to change - Ensure that you always use the latest version -

Order No.: 51MP25WD2441EA | **GTIN (EAN):** 4069025077882

Detailed technical description: Apol31Sf,1245x200,3800lm840,DA2



Key data

- Product type: office luminaire
- Product name: Apollon® 31 Surface
- Order No.: 51MP25WD2441EA

Lighting technology | Lamps | Control gear

Component 1

Lighting technology:

- Cover: micro prismatic cover
- Beam angle: wide distribution, 90°
- Symmetry: symmetric
- Light emission: direct distribution
- UGR viewing direction along longitudinal luminaire axis: ≤ 19
- UGR viewing direction along lateral luminaire axis: ≤ 19

Lamps:

- Lamps: with LED
- Rated luminous flux: 3800lm
- Luminous efficacy: 134lm/W
- Colour temperature: 4000K
- Colour rendering index: CRI > 80
- Light colour: 840
- SDCM (Standard Deviation of Colour Matching): MacAdam ≤ 3 SDCM (initial)
- Rated input power: 28W

Operating device:

- Control gear: ECG DALI
- Control: DALI 2

Certificates, Standards

- Protection rating: IP20
- Insulation class: insulation class II (safety insulation)
- Impact resistance: IK02
- Temperature range (operation): -20...+40°C
- Standard: EN 60598-2-22
- Certification, designation: CE

Material, Colour

- housing: sheet steel, coil coated, metallic grey (RAL 9006)
- Colour specification: metallic grey (RAL 9006)
- Cover: micro prismatic cover of PMMA

Mounting

- Mounting method, mounting location: surface-mounted, to the ceiling
- Arrangement: single arrangement

Electrical connection

- Connection: terminal, 5-pole
- Nominal voltage: 220...240V, 50/60Hz, AC

Dimensions, Weight

- Length: 1245mm
- Width: 200mm
- Height: 44mm
- Weight: 3.4kg

Service life

- Rated service life: 50000h (L80/B50) at AT = 25°C

Order No.: 51MP25WD2441EA | **GTIN (EAN):** 4069025077882

Dimensions: Apol31Sf,1245x200,3800lm840,DA2

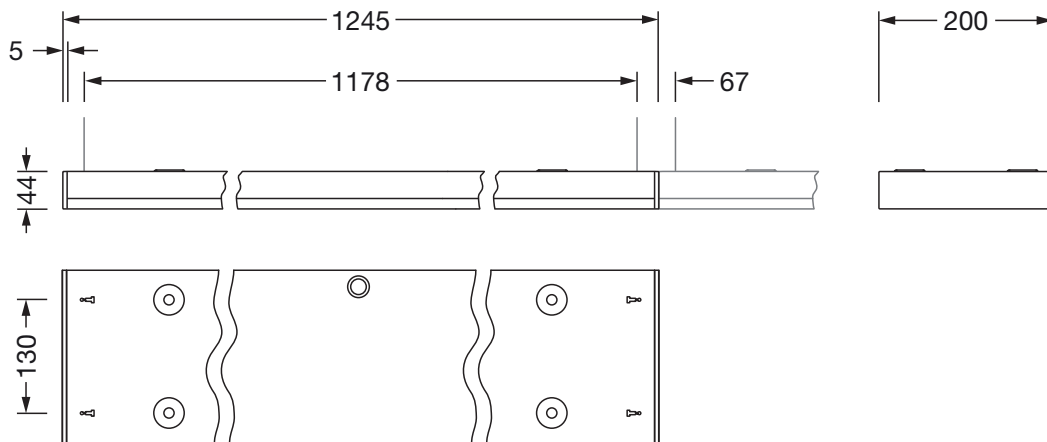

It is mandatory that the assembly instructions must be observed when planning and installing the electrical installation (to be found at www.siteco.com)

Tolerances related to thermal, electrical and photometric data according to IEC 62722

Issued 09.04.2025 - Modifications and errors subject to change - Ensure that you always use the latest version -