

Order No.: 5LZ950400A | **GTIN (EAN):** 4069025243003

Product description: SCon11HWi,surf-mount-hous,surf,plast,wh



SITECO Connect 11H Wireless, surface-mounted housing, installation type: surface-mounted, control gear: Bluetooth® Mesh, housing, of plastic, white, diameter: 105mm, height: 25mm, surface-mounted housing, local control - self-sufficient standalone sensors, dimmable, protection rating (complete): IP54, certification: CE, UKCA, permissible operating ambient temperature: 0..+50°C, packaging unit: 1 piece

IP 54 CE

Wt. (kg): 0.6
GTIN (EAN): 4069025243003

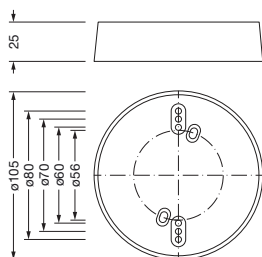

It is mandatory that the assembly instructions must be observed when planning and installing the electrical installation (to be found at www.siteco.com)

Tolerances related to thermal, electrical and photometric data according to IEC 62722

Issued 11.04.2025 - Modifications and errors subject to change - Ensure that you always use the latest version -

Order No.: 5LZ950400A | **GTIN (EAN):** 4069025243003

Detailed technical description: SCon11HWi,surf-mount-hous,surf,plast,wh



Key data

- System family: SITECO Connect 11H Wireless
- Product type: surface-mounted housing
- Product name: SITECO Connect 11H Wireless
- Order No.: 5LZ950400A

Lighting technology | Lamps | Control gear

Component 1

Operating device:

- Control: Bluetooth® Mesh, dimmable

Certificates, Standards

- Protection rating: IP54
- Temperature range (operation): 0...+50°C
- Certification, designation: CE, UKCA

Material, Colour

- housing: plastic, white
- Colour specification: white

Mounting

- Mounting method, mounting location: surface-mounted, to the ceiling
- Supplement: only suitable for use in indoor areas

Dimensions, Weight

- Diameter: 105mm
- Height: 25mm
- Weight: 0.6kg

Order No.: 5LZ950400A | **GTIN (EAN):** 4069025243003

Dimensions: SCon11HWi,surf-mount-hous,surf,plast,wh

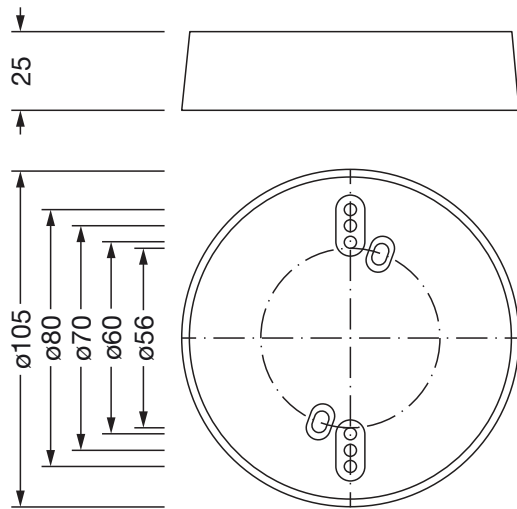

It is mandatory that the assembly instructions must be observed when planning and installing the electrical installation (to be found at www.siteco.com)

Tolerances related to thermal, electrical and photometric data according to IEC 62722

Issued 11.04.2025 - Modifications and errors subject to change - Ensure that you always use the latest version -