

**Order No.:** 5LZ930206 | **GTIN (EAN):** 4058352385999

**Product description:** SCon11,K-BusCoupl

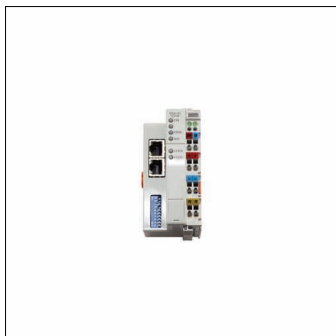

SITECO Connect 11K-Bus coupler, central control - connection to lighting or building management, installation type: recessed, installation location: in an electrical distributor, protection rating (complete): IP20, certification: CE, voltage: 24V, voltage type: DC, 1 x K-Bus, packaging unit: 1 piece

IP 20 

Wt. (kg): 0.1  
GTIN (EAN): 4058352385999

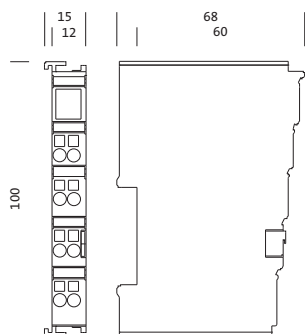

It is mandatory that the assembly instructions must be observed when planning and installing the electrical installation (to be found at [www.siteco.com](http://www.siteco.com))

Tolerances related to thermal, electrical and photometric data according to IEC 62722

Issued 09.04.2025 - Modifications and errors subject to change - Ensure that you always use the latest version -

**Order No.:** 5LZ930206 | **GTIN (EAN):** 4058352385999

**Detailed technical description:** SCon11,K-BusCoupl

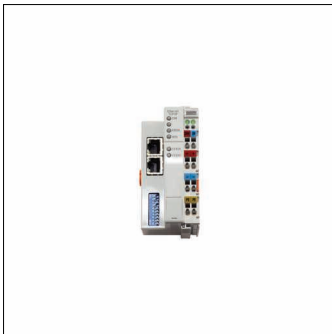

#### Key data

- System family: Siteco Connect 11
- Product type: control unit
- Product name: SITECO Connect 11
- Order No.: 5LZ930206

#### Certificates, Standards

- Protection rating: IP20
- Temperature range (operation): -25...+60°C
- Certification, designation: CE

#### Material, Colour

- Colour specification: grey

#### Mounting

- Mounting method, mounting location: recessed, in an electrical distributor

#### Electrical connection

- Nominal voltage: 24V, DC

#### Dimensions, Weight

- Length: 100mm
- Width: 44mm
- Height: 68mm
- Weight: 0.1kg

#### Inputs

##### 1x K-Bus

- Option: system current max. 500mA

**Order No.:** 5LZ930206 | **GTIN (EAN):** 4058352385999

**Dimensions:** SCon11,K-BusCoupl

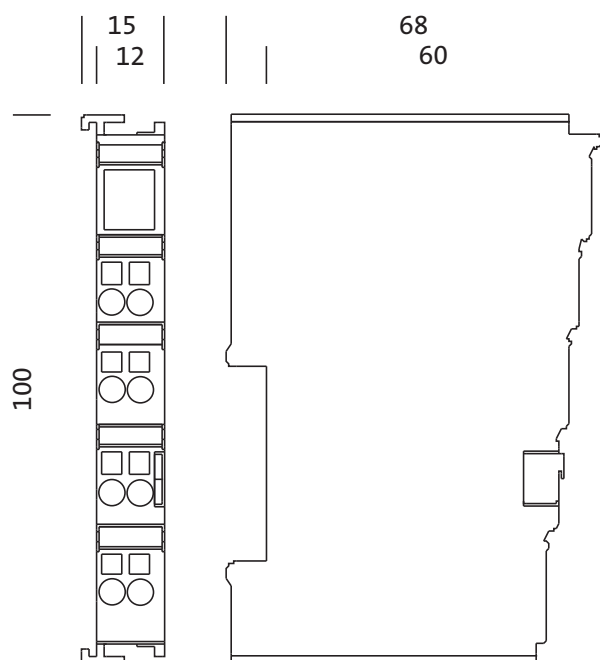

It is mandatory that the assembly instructions must be observed when planning and installing the electrical installation (to be found at [www.siteco.com](http://www.siteco.com))

Tolerances related to thermal, electrical and photometric data according to IEC 62722

Issued 09.04.2025 - Modifications and errors subject to change - Ensure that you always use the latest version -