

Order No.: 5LZ930200 | GTIN (EAN): 4058352385944

Product description: SCon11,DALI2term,centCtrl,K-Bus



SITECO Connect 11 DALI-2 terminal, central control, installation type: recessed, installation location: in an electrical distributor, protection rating (complete): IP20, certification: CE, voltage: 24V, voltage type: DC, 1 x K-Bus, 2 x digital switching contact, 1 x DALI-2, packaging unit: 1 piece

IP 20 

Wt. (kg): 0.1  
GTIN (EAN): 4058352385944

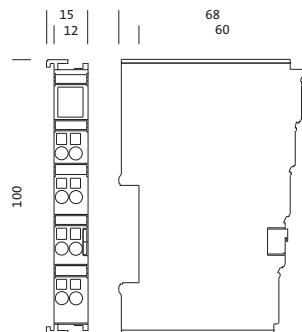

It is mandatory that the assembly instructions must be observed when planning and installing the electrical installation (to be found at [www.siteco.com](http://www.siteco.com))

Tolerances related to thermal, electrical and photometric data according to IEC 62722

Issued 29.09.2023 - Modifications and errors subject to change - Ensure that you always use the latest version -

Order No.: 5LZ930200 | GTIN (EAN): 4058352385944

Detailed technical description: SCon11,DALI2term,centCtrl,K-Bus



#### Key data

- System family: Siteco Connect 11
- Product type: lighting management components
- Product name: SITECO Connect 11
- Order No.: 5LZ930200

#### Certificates, Standards

- Protection rating: IP20
- Temperature range (operation): 0..+55°C
- Certification, designation: CE

#### Material, Colour

- Colour specification: grey

#### Mounting

- Mounting method, mounting location: recessed, in an electrical distributor

#### Electrical connection

- Nominal voltage: 24V, DC

#### Dimensions, Weight

- Length: 100mm
- Width: 12mm
- Height: 68mm
- Weight: 0.1kg

#### Inputs

##### 1x K-Bus

- Option: system current 55mA

##### 2x digital switching contact

- Option: for easy commissioning

#### Outputs

##### 1x DALI-2

- Connection: plug-in terminal, 2x 2-pole, max. 2.5mm<sup>2</sup>
- Protocol: according to current DALI-2 standard
- Feature: integrated power supply (250mA per DALI line)

Order No.: 5LZ930200 | GTIN (EAN): 4058352385944

Dimensions: SCon11,DALI2term,centCtrl,K-Bus

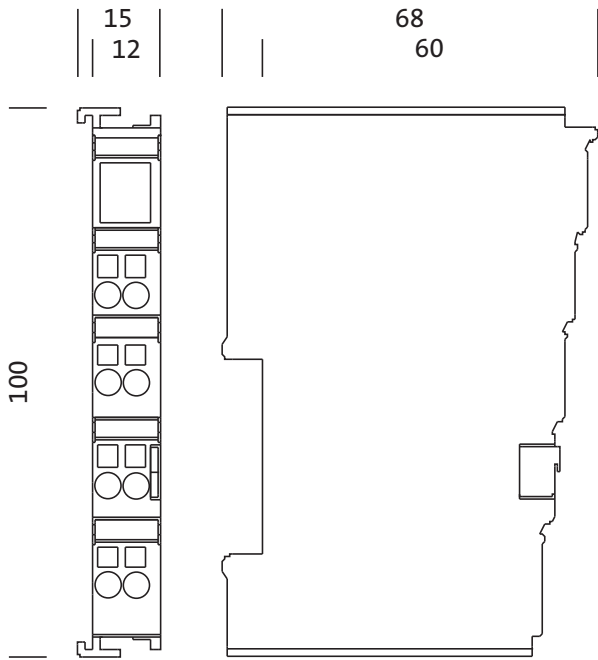

It is mandatory that the assembly instructions must be observed when planning and installing the electrical installation (to be found at [www.siteco.com](http://www.siteco.com))  
Tolerances related to thermal, electrical and photometric data according to IEC 62722  
Issued 29.09.2023 - Modifications and errors subject to change - Ensure that you always use the latest version -