

Order No.: 51MP25WM2441EA | **GTIN (EAN):** 4069025077967

Product description: Apol31Sf,1245x200,3800lm840,ML



Apollon® 31 Surface, office luminaire, primary optical cover: micro prismatic cover, of PMMA, light emission: direct distribution, primary light characteristic: symmetric, installation type: surface-mounted, LED, rated luminous flux: 3.800lm, luminous efficacy: 139lm/W, light colour: 840, colour temperature: 4000K, control gear: ON/OFF Multilumen, with terminal, 3-pole, mains connection: 220..240V, AC, 50/60Hz, rated input power: 27W, housing, of sheet steel, coil coated, metallic grey (RAL 9006), length: 1.245mm, width: 200mm, height: 44mm, protection rating (complete): IP40, insulation class (complete): insulation class II (safety insulation), certification: CE, ENEC, UKCA, impact resistance: IK02, permissible operating ambient temperature: - 20...+40°C, packaging unit: 1 piece

IP 40

Lamps:	LED
Wt. (kg):	3.4
GTIN (EAN):	4069025077967

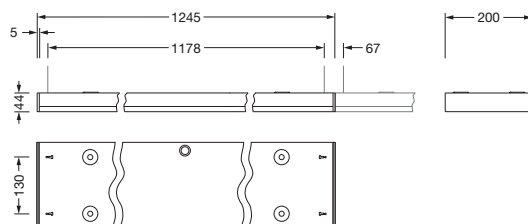

It is mandatory that the assembly instructions must be observed when planning and installing the electrical installation (to be found at www.siteco.com)

Tolerances related to thermal, electrical and photometric data according to IEC 62722

Issued 08.08.2025 - Modifications and errors subject to change - Ensure that you always use the latest version -

Order No.: 51MP25WM2441EA | **GTIN (EAN):** 4069025077967

Detailed technical description: Apol31Sf,1245x200,3800lm840,ML



Key data

- Product type: office luminaire
- Product name: Apollon® 31 Surface
- Order No.: 51MP25WM2441EA

Lighting technology | Lamps | Control gear

Component 1

Lighting technology:

- Cover: micro prismatic cover
- Beam angle: wide distribution, 90°
- Symmetry: symmetric
- Light emission: direct distribution
- UGR viewing direction along longitudinal luminaire axis: ≤ 19
- UGR viewing direction along lateral luminaire axis: ≤ 19

Lamps:

- Lamps: with LED
- Rated luminous flux: 3800lm
- Luminous efficacy: 139lm/W
- Colour temperature: 4000K
- Colour rendering index: CRI > 80
- Light colour: 840
- SDCM (Standard Deviation of Colour Matching): MacAdam ≤ 3 SDCM (initial)
- Rated input power: 27W
- Supplement: with through-wiring, luminous flux adjustable on luminaire in four steps (2900/3600/4100/4700lm), connected load according to luminous flux setting (23/27/33/38W)

Operating device:

- Control: ON/OFF Multilumen

Certificates, Standards

- Protection rating: IP40
- Insulation class: insulation class II (safety insulation)
- Impact resistance: IK02
- Temperature range (operation): -20...+40°C
- Certification, designation: CE, ENEC, UKCA

Material, Colour

- housing: sheet steel, coil coated, metallic grey (RAL 9006)
- Colour specification: metallic grey (RAL 9006)
- Cover: micro prismatic cover of PMMA

Mounting

- Mounting method, mounting location: surface-mounted, to the ceiling
- Arrangement: single arrangement

Electrical connection

- Connection: terminal, 3-pole
- Nominal voltage: 220...240V, 50/60Hz, AC

Dimensions, Weight

- Length: 1245mm
- Width: 200mm
- Height: 44mm
- Weight: 3.4kg

Service life

- Rated service life: 50000h (L80/B50) at AT = 25°C

Order No.: 51MP25WM2441EA | **GTIN (EAN):** 4069025077967

Dimensions: Apol31Sf,1245x200,3800lm840,ML

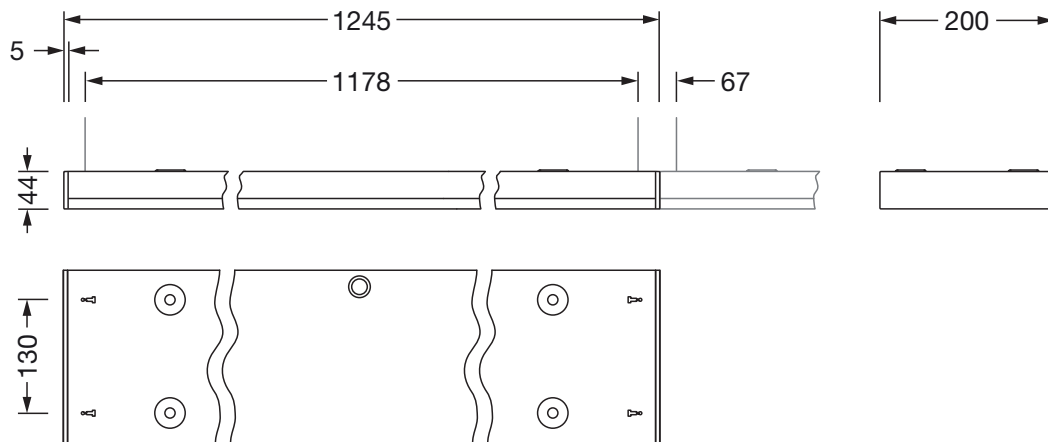

It is mandatory that the assembly instructions must be observed when planning and installing the electrical installation (to be found at www.siteco.com)

Tolerances related to thermal, electrical and photometric data according to IEC 62722

Issued 08.08.2025 - Modifications and errors subject to change - Ensure that you always use the latest version -