

Order No.: 5LZ904731A | **GTIN (EAN):** 4058352580318

Product description: DA2psh.btn.interf,rec



DALI2push button interface, slave, central control - connection to lighting or building management, dimmable, installation type: recessed, installation location: in the switch box, of plastic, protection rating (complete): IP20, certification: CE, 4 x push button input, 1 x DALI-2, packaging unit: 1 piece

IP 20

Wt. (kg): 0.1
GTIN (EAN): 4058352580318

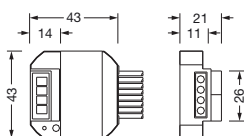

It is mandatory that the assembly instructions must be observed when planning and installing the electrical installation (to be found at www.siteco.com)

Tolerances related to thermal, electrical and photometric data according to IEC 62722

Issued 30.10.2025 - Modifications and errors subject to change - Ensure that you always use the latest version -

Order No.: 5LZ904731A | **GTIN (EAN):** 4058352580318

Detailed technical description: DA2psh.bttm.interf,rec



Key data

- System family: SITECO Connect 11, SITECO Connect 21
- Product type: push button interface
- Product name: DALI2
- Order No.: 5LZ904731A

Lighting technology | Lamps | Control gear

Component 1

Operating device:

- Control: DALI 2, dimmable

Certificates, Standards

- Protection rating: IP20
- Temperature range (operation): 0..+50°C
- Certification, designation: CE

Material, Colour

- housing: plastic, grey
- Colour specification: grey

Mounting

- Mounting method, mounting location: recessed, in the switch box
- Supplement: only suitable for use in indoor areas

Dimensions, Weight

- Length: 42mm
- Width: 42mm
- Height: 20mm
- Weight: 0.1kg

Inputs

4x push button input

- Connection: cable pair (2-pole), A=0.25mm², colour coding of cables, with pre-assembled wire end sleeve
- Feature: maximum of 4 potential-free push buttons can be connected

Outputs

1x DALI-2

- Connection: plug-in terminal, 2-pole, max. 2.5mm²
- System current: 6mA

Order No.: 5LZ904731A | **GTIN (EAN):** 4058352580318

Dimensions: DA2psh.bttf,rec

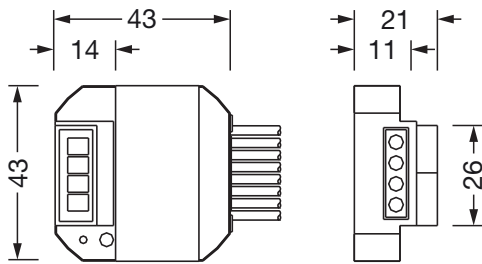

It is mandatory that the assembly instructions must be observed when planning and installing the electrical installation (to be found at www.siteco.com)

Tolerances related to thermal, electrical and photometric data according to IEC 62722

Issued 30.10.2025 - Modifications and errors subject to change - Ensure that you always use the latest version -